



**Electrolux**  
PROFESSIONAL

## Modular Cooking Range Line 700XP Two Wells Freestanding Electric Fryer 7 liter

ITEM # \_\_\_\_\_

MODEL # \_\_\_\_\_

NAME # \_\_\_\_\_

SIS # \_\_\_\_\_

AIA # \_\_\_\_\_



**371078 (E7FREH2BF0)**

7+7-lt electric Fryer free standing with 2 "V" shape wells (external heating elements), 2 baskets and lids included

**371141 (E7FREH22FN)**

7+7-lt electric Fryer free standing with 2 "V" shape wells (external heating elements), 2 baskets and lids included

### Short Form Specification

**Item No.** \_\_\_\_\_

To be installed on height adjustable feet in stainless steel. High efficiency infrared heating elements (10.8kW) attached to the outside of the well. Deep drawn V-shaped well. Oil drains through a tap into a container under the well. Melting function to safely heat-up solid shortening used to fry products. Exterior panels in stainless steel with Scotch Brite finish. One piece pressed work top in 1.5 mm thick stainless steel. Right-angled side edges to allow flush-fitting junction between units.

### Main Features

- Unit to be mounted on height adjustable feet in stainless steel.
- Deep drawn V-Shaped wells.
- High efficiency infrared heating elements are attached to the outside of the wells.
- Thermostatic regulation of oil temperature up to a maximum of 185 °C.
- Overheat protection thermostat as standard on all units.
- Oil drains through a tap into a drainage container positioned under the wells.
- All major compartments located in front of unit for ease of maintenance.
- IPx4 water protection.
- Optional portable oil quality monitoring tool (code 9B8081) for efficient oil management.

### Construction

- All exterior panels in Stainless Steel with Scotch Brite finishing.
- One piece pressed 1.5 mm work top in Stainless steel.
- Model has right-angled side edges to allow flush fitting joints between units, eliminating gaps and possible dirt traps.
- Interior of well with rounded corners for ease of cleaning.

### Sustainability



- This model is compliant with Swiss Energy Efficiency Ordinance (730.02).

### Included Accessories

- 2 of Door for open base PNC 206350 cupboard
- 2 of Basket for 7lt top and free PNC 921608 standing fryers

### Optional Accessories

- Junction sealing kit PNC 206086 ☐
- Kit 4 wheels - 2 swivelling with brake - it is mandatory to install Base support and wheels PNC 206135 ☐
- Flanged feet kit PNC 206136 ☐
- Support for bridge type installation, 1000mm (only for 371141) PNC 206138 ☐
- Support for bridge type installation, 1200mm (only for 371078) PNC 206139 ☐
- Frontal kicking strip for concrete installation, 800mm PNC 206148 ☐

**APPROVAL:** \_\_\_\_\_



Experience the Excellence  
[www.electroluxprofessional.com](http://www.electroluxprofessional.com)

- |  |            |                          |
|--|------------|--------------------------|
| • Frontal kicking strip for concrete installation, 1000mm                        | PNC 206150 | <input type="checkbox"/> |
| • Frontal kicking strip for concrete installation, 1200mm                        | PNC 206151 | <input type="checkbox"/> |
| • Frontal kicking strip for concrete installation, 1600mm                        | PNC 206152 | <input type="checkbox"/> |
| • Frontal kicking strip, 800mm (not for refr-freezer base)                       | PNC 206176 | <input type="checkbox"/> |
| • Frontal kicking strip, 1000mm (not for refr-freezer base)                      | PNC 206177 | <input type="checkbox"/> |
| • Frontal kicking strip, 1200mm (not for refr-freezer base)                      | PNC 206178 | <input type="checkbox"/> |
| • Frontal kicking strip, 1600mm (not for refr-freezer base)                      | PNC 206179 | <input type="checkbox"/> |
| • Kit 4 feet for concrete installation (not for 900 line free standing grill)    | PNC 206210 | <input type="checkbox"/> |
| • Pair of side kicking strips  | PNC 206249 | <input type="checkbox"/> |
| • Pair of side kicking strips for concrete installation                          | PNC 206265 | <input type="checkbox"/> |
| • Chimney upstand, 800mm (only for 371078)                                       | PNC 206304 | <input type="checkbox"/> |
| • Right and left side handrails  | PNC 206307 | <input type="checkbox"/> |
| • Back handrail 800 mm   | PNC 206308 | <input type="checkbox"/> |
| • Door for open base cupboard  | PNC 206350 | <input type="checkbox"/> |
| • Base support for feet or wheels - 800mm (700/900)                              | PNC 206367 | <input type="checkbox"/> |
| • Base support for feet or wheels - 1200mm (700/900)                             | PNC 206368 | <input type="checkbox"/> |
| • Base support for feet or wheels - 1600mm (700/900)                             | PNC 206369 | <input type="checkbox"/> |
| • Base support for feet or wheels - 2000mm (700/900)                             | PNC 206370 | <input type="checkbox"/> |
| • Rear paneling - 800mm (700/900)  | PNC 206374 | <input type="checkbox"/> |
| • Rear paneling - 1000mm (700/900)   | PNC 206375 | <input type="checkbox"/> |
| • Rear paneling - 1200mm (700/900)   | PNC 206376 | <input type="checkbox"/> |
| • Chimney grid net, 400mm (700XP/900)  | PNC 206400 | <input type="checkbox"/> |
| • 2 side covering panels for free standing appliances                            | PNC 216000 | <input type="checkbox"/> |
| • Basket for 7lt top and free standing fryers                                    | PNC 921608 | <input type="checkbox"/> |
| • Filter for fryer oil collection basin for 7lt, 14lt, 15lt free standing fryers | PNC 921693 | <input type="checkbox"/> |



**Electrolux**  
PROFESSIONAL

## Modular Cooking Range Line 700XP Two Wells Freestanding Electric Fryer 7 liter

Front

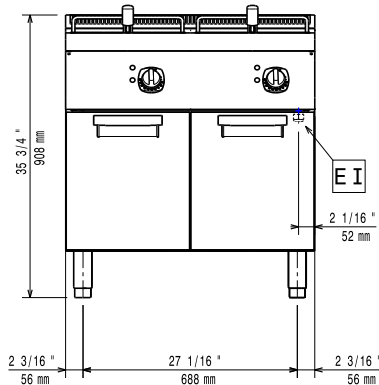

Side

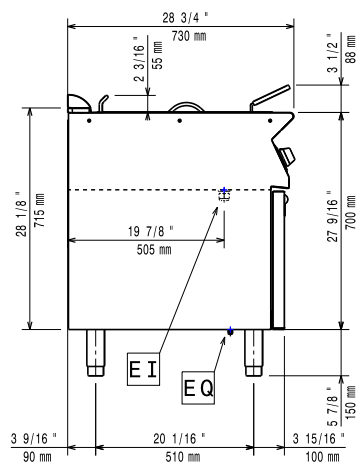

EI = Electrical inlet (power)  
EQ = Equipotential screw

Top

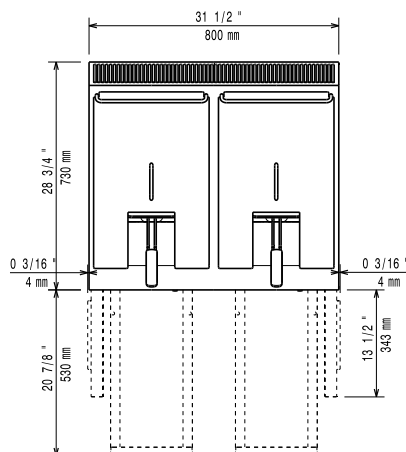

### Electric

#### Supply voltage:

371078 (E7FREH2BF0)

380-400 V/3N ph/50-60 Hz

371141 (E7FREH22FN)

230 V/3 ph/50/60 Hz

#### Predisposed for:

Total Watts: 10.8 kW

### Key Information:

If appliance is set up or next to or against temperature sensitive furniture or similar, a safety gap of approximately 150 mm should be maintained or some form of heat insulation fitted.

#### Usable well dimensions

(width): 240 mm

#### Usable well dimensions

(height): 235 mm

#### Usable well dimensions

(depth): 380 mm

#### Well capacity:

5.5 lt MIN; 7 lt MAX

#### Thermostat Range:

105 °C MIN; 185 °C MAX

#### Net weight:

69 kg

#### Shipping weight:

81 kg

#### Shipping height:

1130 mm

#### Shipping width:

1140 mm

#### Shipping depth:

820 mm

#### Shipping volume:

860 mm

#### Certification group:

0.8 m<sup>3</sup>

#### Certification group:

371078 (E7FREH2BF0) EFE72M07

#### Certification group:

371141 (E7FREH22FN) N7FE2



Modular Cooking Range Line  
700XP Two Wells Freestanding Electric Fryer 7 liter

The company reserves the right to make modifications to the products without prior notice. All information correct at time of printing.

2025.05.26